

**WESTIN**  
HOTELS & RESORTS

## Set for Success

Whether you're catching up with colleagues, convening for a celebration, a press conference or a fashion show, our planners are here to make your meeting or event effortless at The Westin Paris - Vendôme. When you hold your meetings at a Westin hotel, we take care of the details so you and your group can enjoy critical time and space to innovate, free from distractions.

**THE WESTIN  
PARIS - VENDÔME**  
3 rue de Castiglione  
75001 Paris  
France

T +33 (0)1 44 77 11 11  
F +33 (0)1 44 77 14 60  
westin.com/paris

## Stay Productive

### CONNECT

The hotel offers a total of 13 meeting rooms with 2,000 square meters (21,500 square feet) of space for productivity, focus and prestigious events for up to 2000 guests. The Westin Paris - Vendôme meeting space is anchored by the largest conference room with daylight in the city center and three ballrooms adorned with impressive second empire-style frescos.

Clear thinking begins with Westin Clutter-Free Meetings, helping planners and guests stay focused with spacious, open rooms, essential amenities, and invigorating SuperFoodsRx menu selections. Streamlined stations offer all the necessities for productivity, from pens and paper to refreshing beverages.

### RECHARGE

Unwind in our elegantly designed guestrooms and suites. Each of our 428 accommodation spaces features our Heavenly® Bed, High-Speed Internet and WiFi access, refreshment center, work desk and other essential amenities for a fulfilling stay.

Our guestrooms and suites are welcoming and designed by Sybille de Margerie:

Superior Rooms	204	18/25 sq m
Deluxe Rooms	86	27/35 sq m
View Rooms	58	18/25 sq m
Junior Suites	36	35/50 sq m
Junior Suites with View	10	35/50 sq m
Prestige Suites	13	44/56 sq m
Ambassador Suites	11	60/75 sq m
Royal Suites with View	9	90/120 sq m
Presidential Suite with View	1	150 sq m
Total	428	

### REVITALIZE OR UNWIND

The Westin WORKOUT® fitness center offers an extensive range of equipment and is open 24 hours a day. Be at your best with our RunWESTIN™ program to re-energize in the Tuileries Garden. Our Six Senses spa invites you to a sensory escape. Experience holistic treatments within one of the spa's six wood cocoons, with treatments by experts and enhanced by a selection of unique products.

### REFRESH

Delicious and healthy meals unite in our SuperFoodsRx menu and seasonal dishes. The restaurant le First invites you to discover a modern and tasty cuisine in an elegant setting designed by Jacques Garcia. In winter or summer, experience La Terrasse, our outdoor haven of tranquility in the heart of Paris. Warm and inviting, the Tuileries Bar serves a selection of savoury snacks, creative cocktails as well as the finest Jing teas and energizing fresh smoothies by The Juicery. The hotel also offers 24-hour In-Room Dining.

### EXPLORE

Ideally situated in Paris' exciting first arrondissement, The Westin Paris - Vendôme offers the best of the City of Light right at your doorstep. In addition to the magnificent views of the city from the hotel — most importantly the iconic Eiffel Tower and Tuileries Garden — you are just moments from the Louvre Museum, the Place Vendôme, the Place de la Concorde and the elegant fashion boutiques of rue du Faubourg-Saint-Honoré. The hotel is also 45 minutes from Charles de Gaulle international airport.

### SEAMLESS SERVICE

Our multilingual staff and 24-hour Clefs d'Or Concierge will help you get the most out of the legendary City of Light. Let us take care of you with services like laundry, dry cleaning and 24-hour business center. Take a deep breath and enjoy the clean and smoke-free air of the hotel.

To begin planning your next Westin event, please visit [westin.com/paris](http://westin.com/paris).

spg.  
Starwood  
Preferred  
Guest

©2017 Marriott International, Inc. All Rights Reserved. Preferred Guest, SPG, Westin and their logos are the trademarks of Marriott International, Inc., or its affiliates. For full terms and conditions, visit [westin.com/paris](http://westin.com/paris).





## Floor Plans

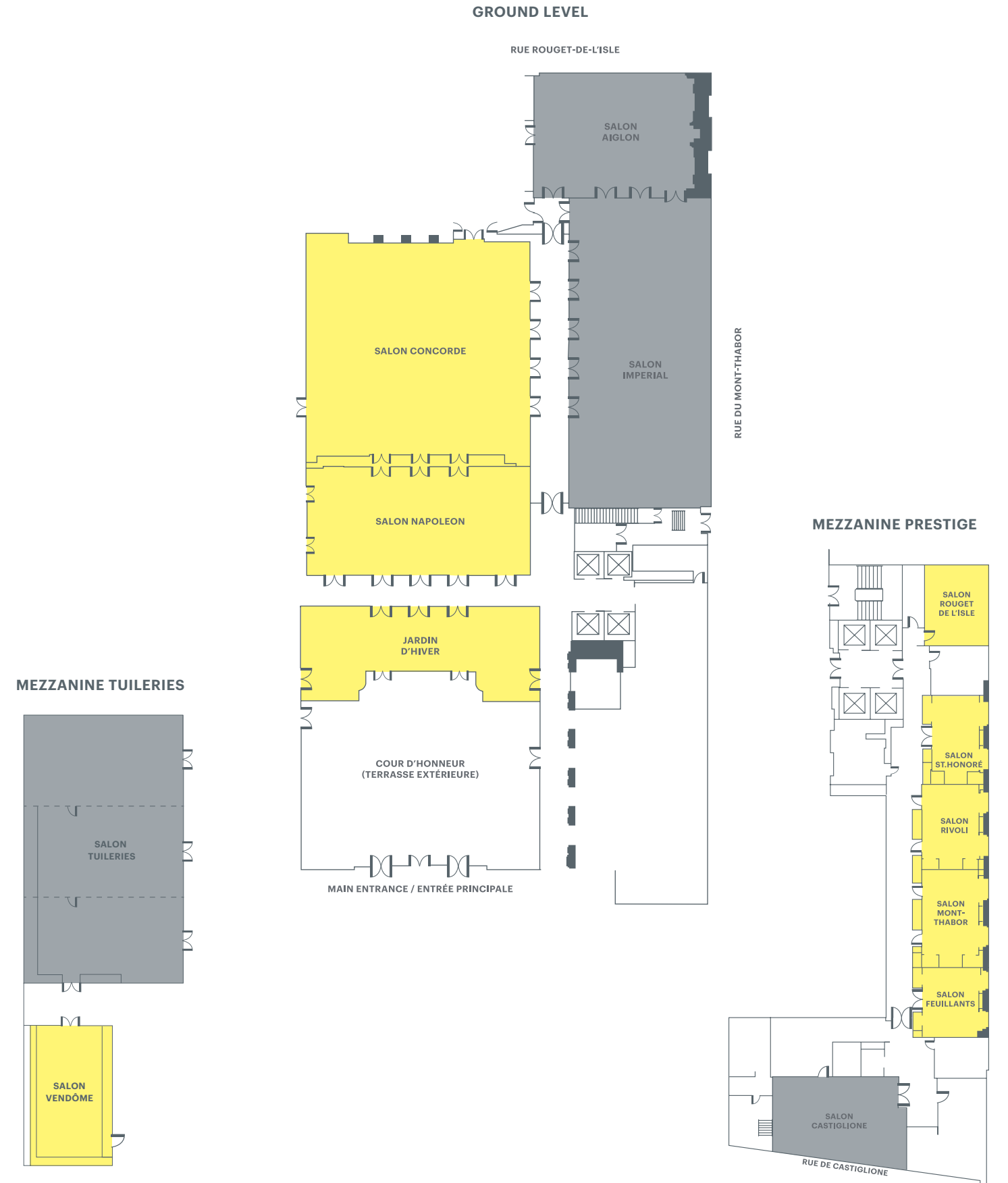

## Capacity Chart

ROOM NAME	TOTAL M <sup>2</sup>	TOTAL SQ. FT	DIMENSIONS (M) (FT)		CEILING (M) (FT)	THEATER	CLASSROOM	U-SHAPE	BOARDROOM	CABARET	COCKTAIL	BANQUET	BUFFET	
<b>GROUND LEVEL</b>														
CONCORDE	414	4456	19,8x21	65x69	6,15	20	600	330	72	64	264	700	550	340
CONCORDE & BALCONY	680	7320	-	-	-	-	720	-	-	-	-	650	-	
NAPOLÉON	202	2174	21x9,6	69x31,5	6	19,8	220	107	55	64	104	250	200	140
JARDIN D'HIVER	126	1356	18x7	59x23	6	19,8	-	-	-	46	-	150	120	80
IMPÉRIAL	367	3983	28,5x13	93,5x42,6	9	29,6	420	217	90	90	192	600	400	240
AIGLON	161	1733	15x11	49,2x36	9	29,6	170	90	40	46	88	200	150	100
CONCORDE / NAPOLÉON	616	6659	-	-	-	-	-	-	-	-	-	900	700	450
CONC. / NAP. / JARDIN D'HIVER	742	8015	-	-	-	-	-	-	-	-	-	1000	820	-
IMPÉRIAL / AIGLON	529	5716	-	-	-	-	-	-	-	-	-	700	550	-
IMPÉRIAL / CONCORDE / AIGLON	943	10201	-	-	-	-	-	-	-	-	-	1400	1100	-
IMPÉRIAL / CONC. / AIGLON / NAP.	1145	12375	-	-	-	-	-	-	-	-	-	1600	1250	-
<b>MEZZANINE TUILERIES</b>														
TUILERIES	225	2422	20,5x11	65,6x36	2,27	7,5	210	90	-	-	120	220	180	160
TUILERIES 1	76	825	11,2x6,8	36,5x22,3	2,27	7,5	70	30	30	34	40	60	60	50
TUILERIES 2	79	849	11,25x7	36,9x23	2,27	7,5	70	30	35	34	40	60	60	50
TUILERIES 3	66	710	11,23x5,9	36,8x19,3	2,27	7,5	70	30	30	34	40	60	60	50
TUILERIES 1 & 2	155	1674	-	-	2,27	7,5	140	70	40	-	80	120	120	100
TUILERIES 2 & 3	145	1559	-	-	2,27	7,5	140	70	40	-	80	120	120	100
VENDÔME	53	570	10,3x5	33,8x16,4	2,3	7,6	70	36	33	36	32	50	50	30
<b>MEZZANINE PRESTIGE</b>														
SAINT-HONORÉ	23	247	3,9x5,9	12,8x19,4	2,3	7,6	20	-	14	15	-	-	-	-
RIVOLI	27	290	4,8x5,6	15,8x18,4	2,3	7,6	24	-	14	15	-	-	-	-
MONT-THABOR	31	333	4,8x6,5	15,8x21,3	2,3	7,6	30	-	17	20	-	-	-	-
FEUILLANTS	25	269	4,8x6,5	15,8x21,3	2,3	7,6	-	-	-	12	-	-	-	-
CASTIGLIONE	62	667	10x6,15	32,8x20,2	2,18	7,1	60	30	21	18	32	70	60	40
ROUGET DE L'ISLE	21	215	5,7x3,7	18,7x12,1	2,18	7,1	-	-	-	8	-	-	-	-